

ASSEMBLY INSTRUCTIONS



S H E L F R E L I A N C E TM



Shelf Reliance LLC

810 N 2800 W

Lindon, UT 84042

Phone: (801) 756-9902

Email: info@shelfreliance.com

www.shelfreliance.com



WARNING:

**DO NOT PULL MORE THAN 1
READY RACK DRAWER OUT
AT THE SAME TIME. THIS MAY
CAUSE THE SYSTEM TO
BECOME TOP HEAVY & TIP.**

FOR EXTRA STABILITY, SECURE UNIT TO THE WALL.

CONTACT US FIRST!



If you have
damaged or
missing parts,
please contact
us by phone
or email.

Note: The picture used in these assembly instructions is a general picture of a Ready Rack. Although your system may vary in size and dimension, these instructions are suited for all Ready Rack Systems.

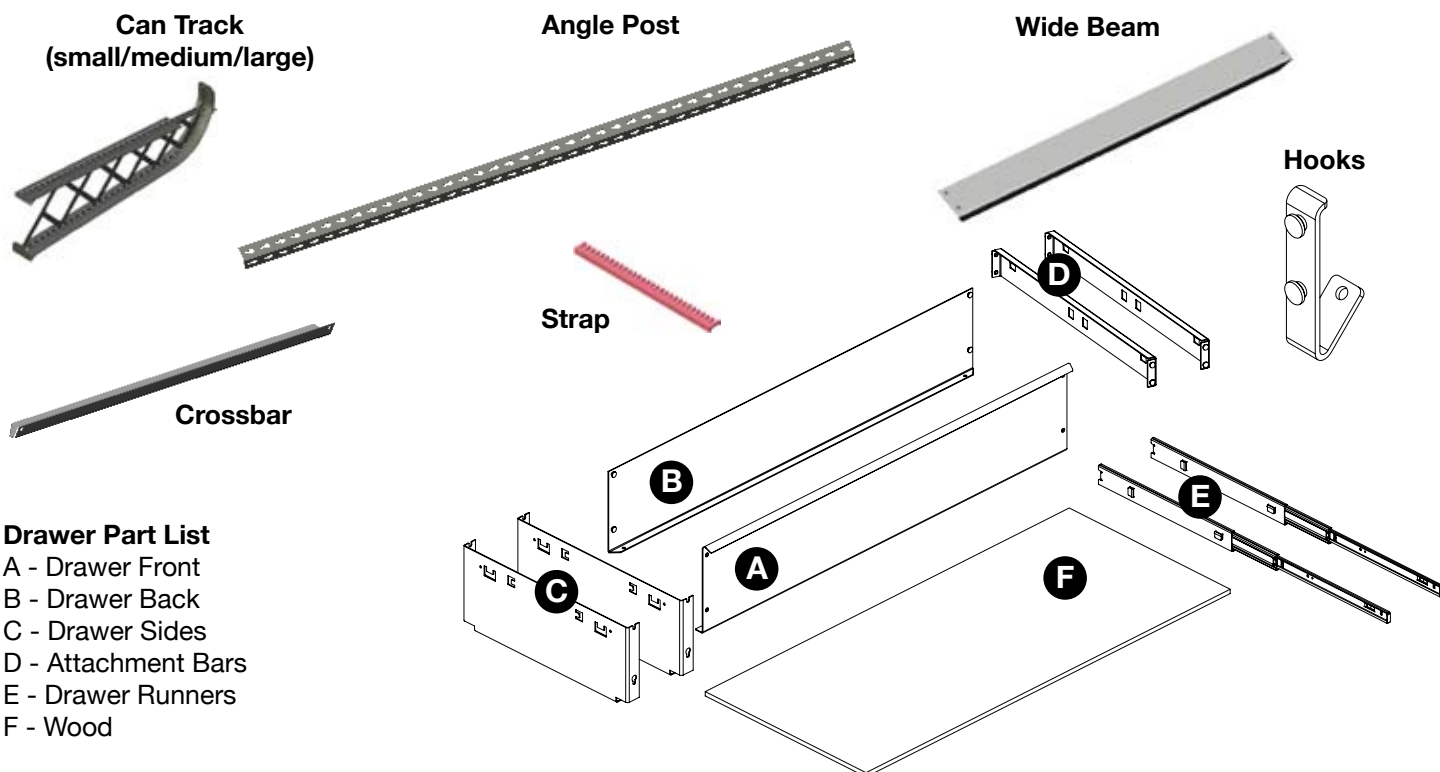
PARTS



TIPS

- 1. Assembly.** Assemble the unit on a sturdy, level surface (not carpet). You should have at least two people help with assembly.
- 2. Tools.** Use a hard rubber or plastic mallet to pound metal pieces together and a screwdriver to pry metal clips. (A hammer may leave dents and chips in the paint).
- 3. Connecting metal pieces.** Pound beams and crossbars with a mallet until the rivets have firmly set into the bottom of the notches. This is extremely important to ensure maximum stability of the frame and proper fit of the Can Tracks. If needed, apply a simple lubricant to the rivets to help them slide into the notches.
- 4. “Notch”** is the “key-hole” segment of an angle post. 
- 5. “Rivet”** is the 1/2” round button that inserts into a notch. 
- 6. “Lip”** is the horizontal edge of a beam. Except for bottom wide beams, the lip of the beam should be on the bottom facing inward. 



CAUTION: Failure to pound all wide beams and crossbars so the rivets are set firmly into the bottom of the notches may cause this product to tip over and could result in serious injury!

FRAME

CAUTION: The surface on which your Ready Rack stands must be level and solid. Beware that the Ready Rack may cause scratches or other damage to tile, linoleum, wood and other fine surfaces. To avoid floor surface damage, we recommend using “Easy Sliders” which can be purchased at Shelf Reliance or home improvement stores. Also, leave enough room behind the Ready Rack during set-up to walk behind it and attach straps. After assembly, the Ready Rack can be backed up against a wall before loading. **Do not load the Ready Rack before moving.**

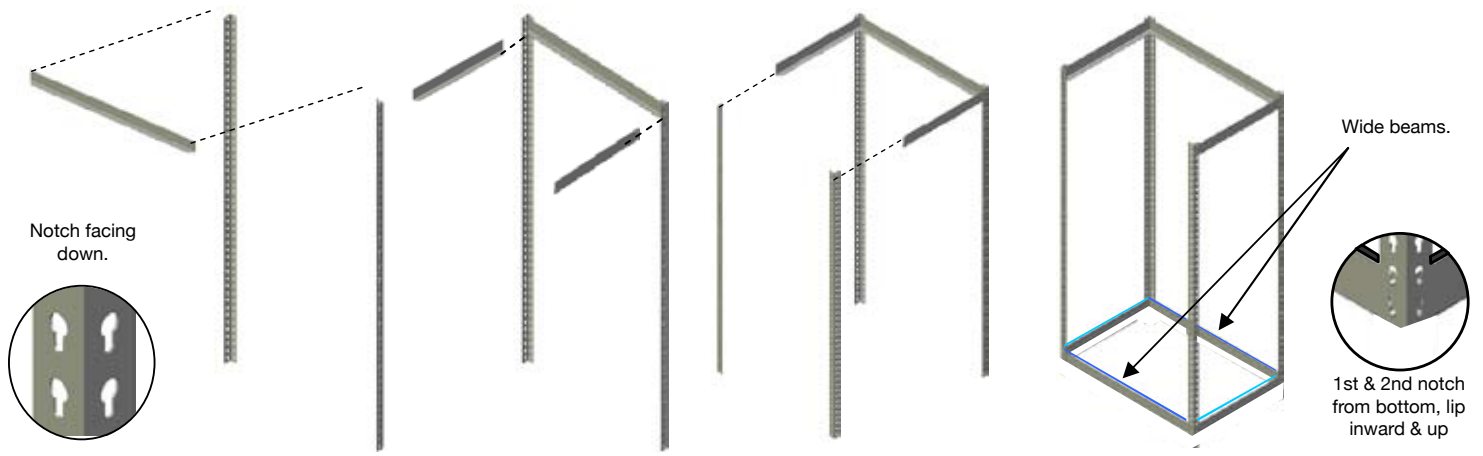

Notch facing down.

Wide beams.

1st & 2nd notch from bottom, lip inward & up

STEP 1

Stand 2 **angle posts** upright. Attach a **long wide beam** (without Shelf Reliance logo) to the top two notches of angle posts. The lip should be on bottom facing inward.

STEP 2

Attach a **short wide beam** to each angle post.

STEP 3

Attach remaining **angle posts**.

STEP 4

Attach **short & long wide beams** to bottom of angle posts, in the 1st & 2nd notches from bottom. This time the lip should be on top facing inward. **Note:** the beam with the Shelf Reliance logo will be attached later.

IMPORTANT: For maximum stability, pound down on beam until rivets are secure in bottom of notches.

CROSSBARS

STEP 5

Attach crossbars (lip on bottom facing inward) to the front and rear side of the frame in the following notches (**counting from very bottom notch up**):

Configuration	Front	Rear
3 small rows, 2 drawers	25, 29, 32, 36, 39, & 43	28, 35, & 42
1 small row, 4 drawers	39, & 43	42
2 large rows, 2 drawers	25, 31, 36, & 42	30 & 41
1 small row, 1 large row, 3 drawers	28, 34, 39 & 43	33 & 42
2 small rows, 1 medium row, 2 drawers	23, 28, 32, 36, 39 & 43	27, 35 & 42
2 small rows, 1 large row, 2 drawers	21, 27, 32, 36, 39 & 43	26, 35 & 42
5 drawers	Don't need tracks	

STEP 6

Top wide beam. Attach the remaining wide beam (with Shelf Reliance logo) to the front top side of the frame.

CAN TRACKS

IF YOUR CONFIGURATION DOESN'T HAVE ANY CAN TRACKS, SKIP TO THE DRAWER ASSEMBLY SECTION.

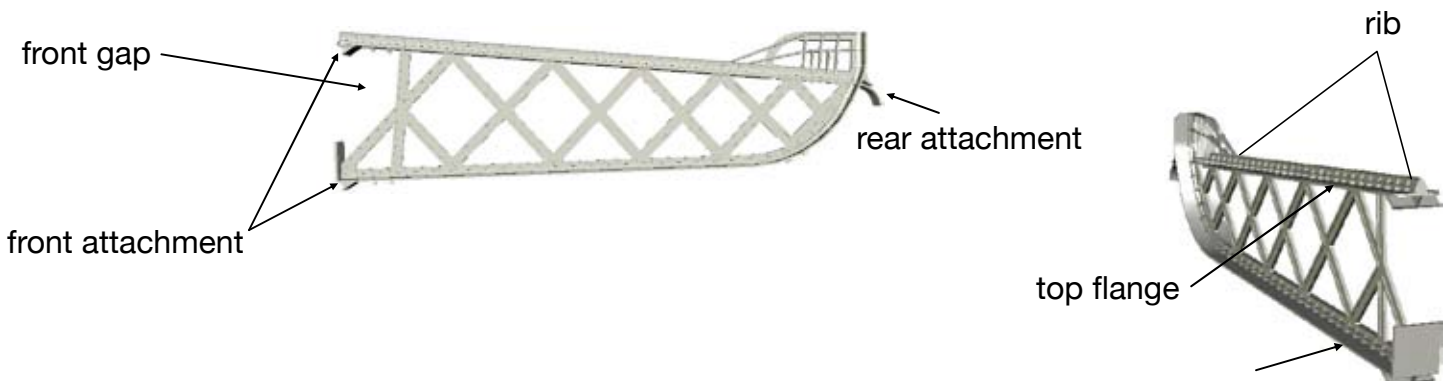

STEP 7

Attachment. Now that the frame is set up, it's time to insert the Can Tracks. Depending on which configuration you purchased, you may have one or two sizes of Can Tracks. **Note:** *If you have different sizes of Can Tracks, remember to put larger Can Tracks on the bottom row and smaller Can Tracks on the top.*

Each Can Track will attach to 3 crossbars (2 on the front, 1 on the rear). To do this,

- 1- Start on the bottom 2 front crossbars and hold the front gap of the Can Track so that it straddles the upper crossbar.
- 2- Insert the rear Can Track attachment into the rear crossbar.
- 3- Press the front attachment of the Can Track downward into the front crossbars.



Next, attach another Can Track parallel to first using the same process.

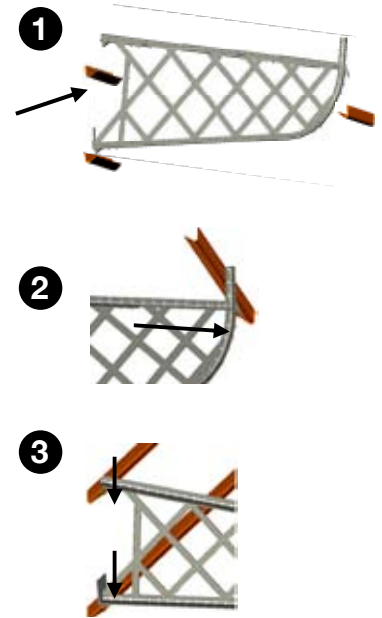

CAN TRACKS

STEP 8

Adjusting for can width.

Now it's time to drop in your first can and adjust the width. To do this,

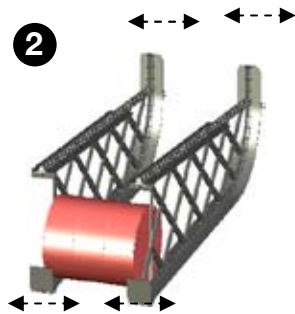

- 1- Place a can on bottom flange of the Can Tracks.

Note: *Small, medium and large Can Tracks each store different sizes of cans. It is important that cans are rotated in the correct Can Tracks to prevent them from binding in the back. The attached "Can Sizing Diagram" will help you determine the appropriate can size.*

- 2- Adjust the Can Tracks side to side so that the can rests about 1/8" away from the center rib.

- 3- Secure the width by attaching a strap to the buttons on the bottom side of Can Tracks. **Note:** *There are 2 different sizes of straps. Use the large straps for #10 cans and other large cans.*

- 4- Now that you have attached the first strap, attach additional straps to the remaining button sets (shown below).

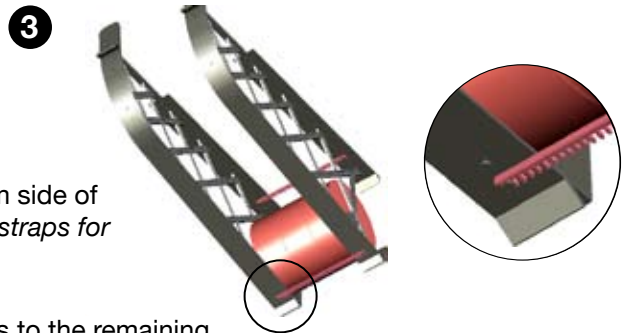

Large Can Track button sets

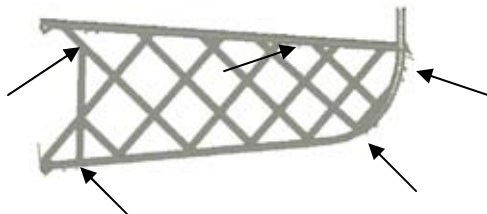

Small/medium Can Track button sets



STEP 9

Insert remaining Can Tracks, if applicable.

Repeat Steps 7 & 8 for each row until all Can Tracks are in place. Notice how buttons on bottom side of Can Tracks are arranged in two's. To connect adjacent Can Tracks, alternate straps between buttons, as shown below.

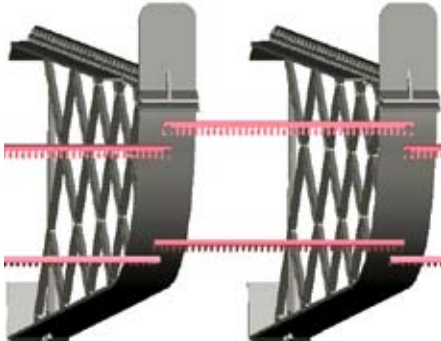

Can rolling.

Cans should roll smoothly. If they don't, or if a can falls in between two Can Tracks, check to see that all straps are attached to buttons at the same increment to create equal spacing in front and back.

DRAWER ASSEMBLY



(Your configuration may vary)

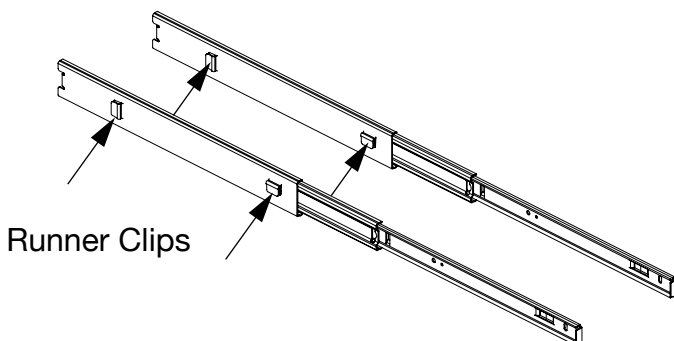

Step 1: Place attachment bars (D) into desired position on the Ready Rack angle posts. Note: The lip on the attachment bar **MUST** be facing up and away from the center of the rack, as show below.

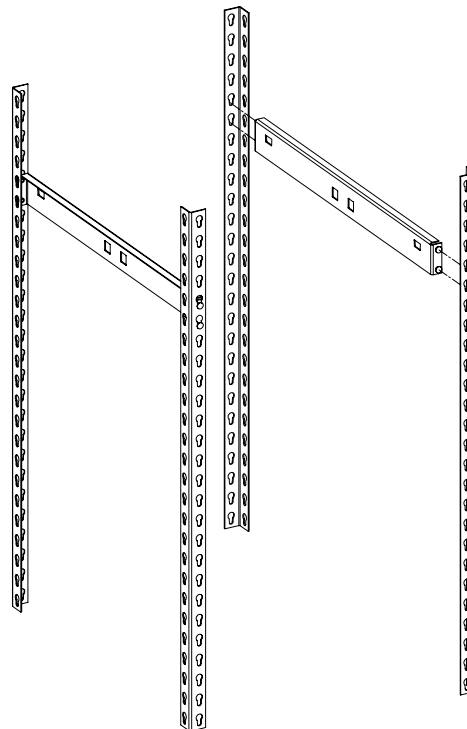

Step 2: Take the drawer runners (E) and using a screwdriver or sturdy piece of metal, pry the runner clips out slightly. This will allow you to more easily attach them to the attachment bars on the frame.

Step 3: The drawer runners are marked L and R. Take the right drawer runner and slide the sideways clip into its hole (as shown to the right). Once the sideways clip is all the way over, insert the second runner clip from the top and press down firmly. Repeat this step with the second drawer runner. **TIP:** Using a rubber mallet when inserting the runner clips will help firmly set the clips in place.

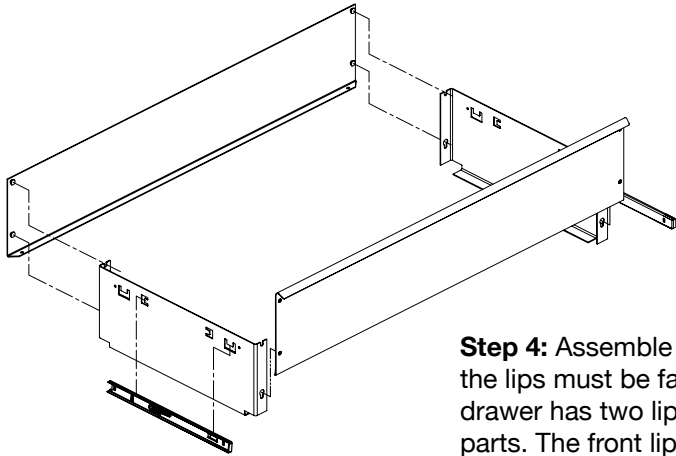
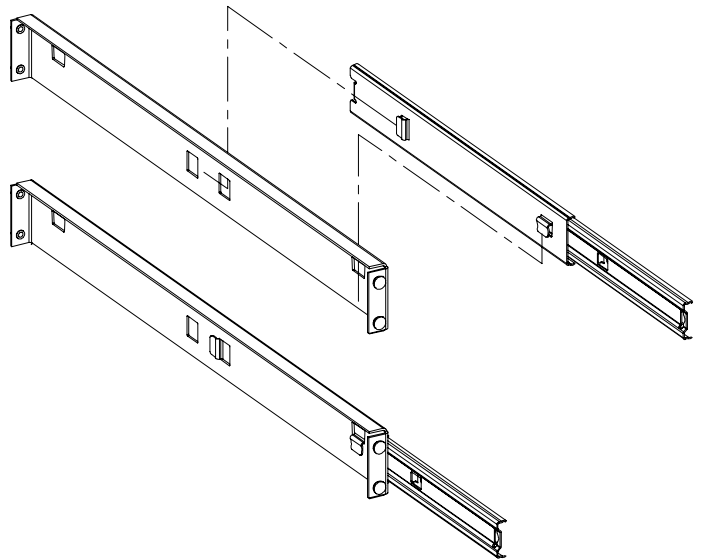

Step 4: Assemble drawer frame by matching up the notches to the holes. All the lips must be facing inward (this will support the wood). Note: The front of the drawer has two lips. The small flat lip faces inward to match the other drawer parts. The front lip curves over to create a drawer handle.

Step 5: Use a rubber mallet to ensure the drawer frame notches are secured into their proper holes. Note: Notches must be secured into their holes, but it is not necessary for them to reach all the way to the bottom of the holes. Having a second person hold the drawer frame while it is assembled is also helpful.

Step 6: Once the drawer frame is completely assembled, attach the drawer sides to the drawer runners by matching the sideways and top clip holes.

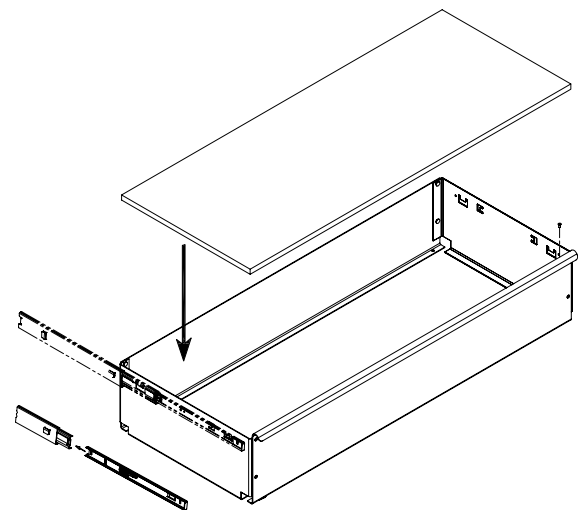

Step 7: Insert wood.

HOOK ATTACHMENT

STEP 1

Place the rivets of your hooks into the notches of your desired angle post location.

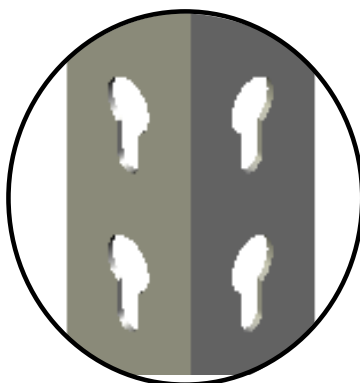

STEP 2

Using a rubber mallet, pound the top lip of your hook until it rests firmly in its notches.

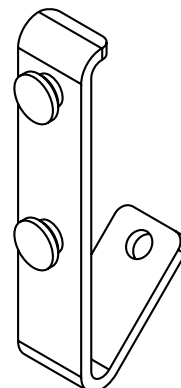

STEP 3

Repeat steps 1 and 2 with your remaining hooks.

CAN SIZING DIAGRAM

The circles below represent various can sizes. To determine which Can Track to use, place can right side up in the center of the chart. The closest visible line to the edge of the can indicates which Can Track to use.

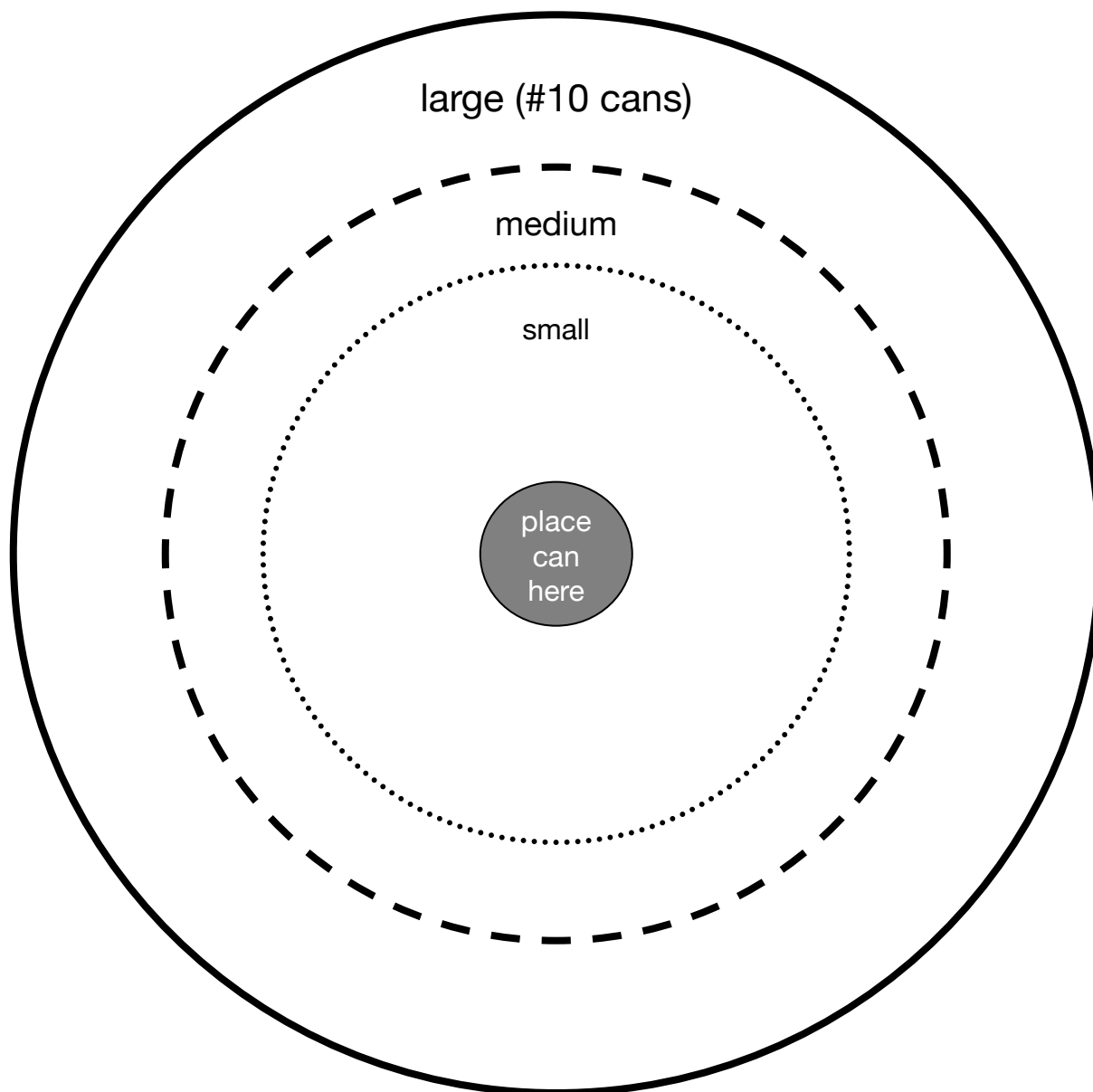
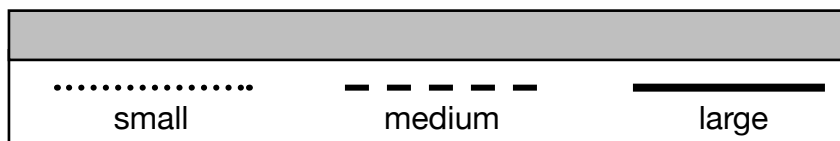

PARTS LIST

Configuration	Angle Post	Wide Crossbeam (long)	Wide Crossbeam (short)	Crossbeam	Can Tracks			Straps		Drawer Kits	Wood Hooks
					(small)	(medium)	(large)	(short)	(long)		
3 small rows, 2 drawers	4	4	4	9	24	0	0	63	0	2	4
2 small rows, 1 large row, 2 drawers	4	4	4	9	16	0	5	42	20	2	4
1 small row, 1 large row, 3 drawers	4	4	4	6	8	0	5	21	20	3	4
5 drawers	4	4	4	0	0	0	0	0	0	5	4
1 small row, 4 drawers	4	4	4	3	8	0	0	21	0	4	4
2 small rows, 1 medium row, 2 drawers	4	4	4	9	16	7	0	63	0	2	4
2 large rows, 2 drawers	4	4	4	6	0	0	10	0	40	2	4

CONGRATULATIONS!

You have finished assembling your Ready Rack and are now ready to conveniently store and rotate your food at your own pace. We hope that by using this system, you will find greater peace of mind as you prepare yourself for whatever the future may hold.

At Shelf Reliance we are committed to preparing people for the future, and we offer a number of other products to accomplish this goal. For further information or questions about our products, please contact our Customer Support Center or visit our website.

www.shelfreliance.com